

**GONZALES COUNTY CAMERA CLUB
PHOTOGRAPHY CONTEST AND EXHIBITION
OCTOBER 2-4, 2015**

Entry Fees: \$5.00 per photo entered in an adult category. Limit of five (5) photos per category.
\$3.00 per photo entered in the Youth category. Photographer must be 18 years of age or younger.

Adult Categories: Animals Digitally Altered Landscapes People Still Life
 Architecture Flowers Miscellaneous Portraits Texas History

Rules:

1. Everyone is encouraged to enter. All entries must be the work of the exhibitor.
2. Photos may be in black and white or in color.
3. All photos must be matted with a photo/picture mat to 11" x 14" with some sort of rigid or semi-rigid backing (poster board, foam board, cardboard, etc.). All layers should be strongly glued or taped together to avoid separation. The viewing area after matting must be at least 7 x 9 inches. Photos will not be displayed in plastic sleeves.
4. Photos that have been substantially altered on a computer prior to printing **MUST** be entered in the Digitally Altered category. Substantial alterations include using software for moving, deleting, adding or changing the images but do not include adjustments for color balance or exposure or conversion from color to black and white. **All entries in the Digitally Altered category MUST include a 4" x 6" print of the original photograph before alteration in order for the judges to see what changes were made.**
5. Previous winning entries in the Come and Take It Photography Contest will not be accepted. GCCC reserves the right to refuse entries deemed in poor taste.
6. The name, address, telephone number and e-mail address of the exhibitor must be recorded in the upper left hand corner on the back of the photo. (See attached example.) The category entered must also be recorded on the back of the photo. Glue or tape an envelope on the back of the photo. In the envelope, place a **3" x 5"** card for display after judging that includes the photographer's name, the category entered and a brief description of the photo. All entries by a single exhibitor must be accompanied by an entry form (see attached) and a **check or money order payable to Gonzales County Camera Club** for all entry fees (we can no longer accept cash for entry fees).
7. All photographs **MUST** be turned in at the Gonzales Chamber of Commerce office at 414 Saint Lawrence Street in Gonzales or received by mail to 1614 Gardien St, Gonzales, Texas 78629 between **Monday, August 31 and noon on Friday, September 25, 2015. ABSOLUTELY NO ENTRIES WILL BE ACCEPTED AFTER THE DEADLINE.** Any exhibitor wishing to have his/her photos returned by mail must include an appropriately addressed mailing container with sufficient postage stamped on the container.

Exhibition:

All photographs will be displayed at **Café on the Square**, 511 Saint Joseph St, Gonzales, Texas during the following hours:
Friday, October 2, 5:00 – 8:00 p.m. **Saturday**, October 3, 1:00 – 6:00 p.m. **Sunday**, October 4, 1:00 – 3:00 p.m.

PRIZES WILL BE AWARDED ON SUNDAY, OCTOBER 4, AT 3:00 P.M. ENTRIES MUST BE PICKED UP BETWEEN 3:00 AND 3:30 P.M. ENTRIES MAY NOT BE PICKED UP BEFORE 3:00 P.M. GCCC IS NOT RESPONSIBLE FOR ENTRIES NOT PICKED UP BY 3:30 P.M. UNLESS PRIOR ARRANGEMENTS HAVE BEEN MADE FOR RETURN MAILING. ENTRIES NOT PICKED UP WILL BE DESTROYED. IF THE EXHIBITOR CANNOT PICK UP HIS/HER OWN PHOTO(S), HE/SHE MAY SEND A SIGNED NOTE WITH ANOTHER PERSON AUTHORIZING THEM TO PICK UP THE PHOTO(S).

Prizes Awarded in Each Category:

1 st Place – Blue ribbon and \$30.00	3 rd Place – White ribbon and \$15.00
2 nd Place – Red ribbon and \$20.00	Honorable Mention – Green ribbon

Best of Show Prize: A Best of Show Photo is selected from the First Place photos in each Adult category. In addition to the prize for 1st Place in that category, the winner will also receive a Best of Show plaque and \$100.00.

Gonzales County Camera Club, Gonzales County Chamber of Commerce and Café on the Square
will not be responsible for any loss or damage of any kind.

*****Please feel free to copy and distribute these rules.*****

CHECKLIST FOR ENTRIES

1. Print name, address, telephone number and e-mail address in upper left corner on back of photo. You may use an address label with your phone number and e-mail address added.
2. Indicate the top of the photo with an arrow on the back of the entry and include the category entered.
3. Attach an envelope to the back of each entry with the category entered written on the outside of the envelope.
4. Include a 3" x 5" index card in the envelope to be used in the display. On the card include:
 - Photographer's name
 - Category entered
 - Brief description or title of photograph
5. Include the Contest Entry Form filled out with the Category and Title of each photo entered. Please use a separate entry form for each photographer.
6. Include a check or money order for the total photos entered (\$5.00 per each entry in an Adult Category, \$3.00 for each Youth Category entry).
7. Include appropriate mailing materials for return of your photos OR make arrangements to pick them up between 3:00 and 3:30 p.m. on October 5.

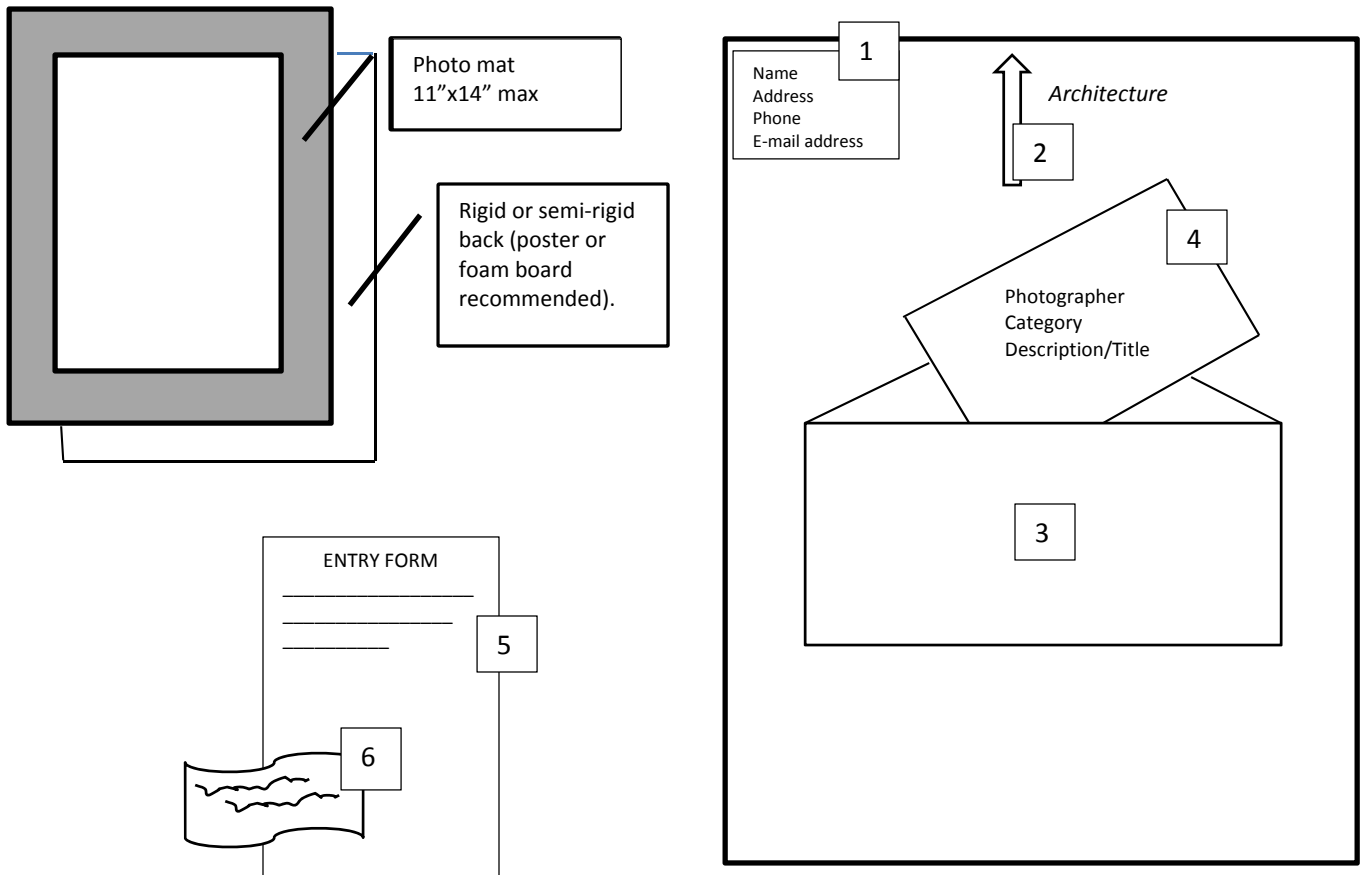

**GONZALES COUNTY CAMERA CLUB
COME AND TAKE IT PHOTOGRAPHY CONTEST ENTRY FORM
2015**

(Please Print)

Photographer _____ Adult Youth (check one)

Address _____ City _____ State _____ Zip _____

E-Mail Address _____ Telephone _____

Please list the Category and Title for all Adult Entries or the Title for all Youth Entries.

	CATEGORY (For Adult Entries)	TITLE (For All Entries)
1		
2		
3		
4		
5		
6		
7		
8		
9		
10		
11		
12		
13		
14		
15		
16		
17		
18		

Check here if adding another page. Enter totals on last page.

Total Number of Photographs Entered: _____

Total Amount of Entry Fees: \$ _____

Check # _____ Money Order